

## DK-LOK<sup>®</sup> VR Series Tube Fittings

DK-LOK VR Series Tube Fitting is an inventive solution for safe installation & leak-tight tubing system, and facilitates visual inspection in installation as well as in service.

### Features

- Outstanding Vibration Resistant Design with patented **HOOK**
- Red Ring in Body facilitates Visual Inspection in Make-Up as well as in Operation
- Sturdy Stainless Steel Construction

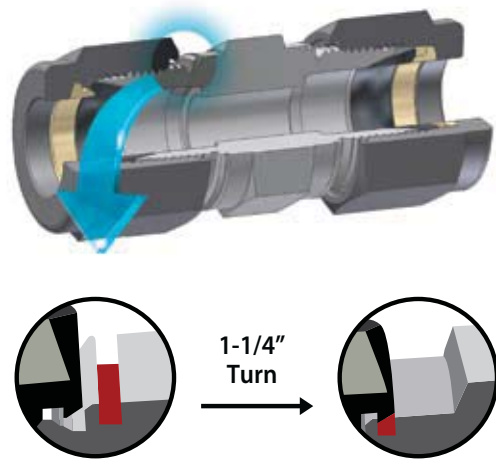

### Patented "HOOK" Design

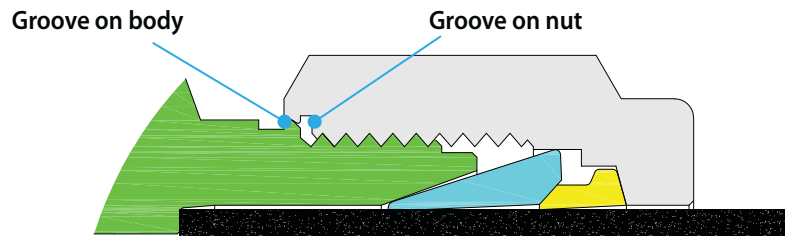

The **Patented Groove** constructed both on Stainless Steel DK-LOK Tube Fitting **Nut** and **Body** locks the Nut up on the Body mechanically at 1 1/4 turns beyond the finger tight.

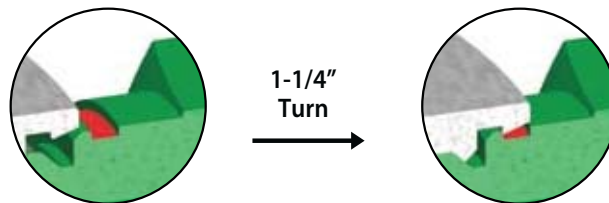

The Hooked (made-up) DK-LOK tube fitting provides **LIFETIME Leak-Tight Sealing** unless the fitting is manually un-tightened by span-

## Prevention of Over-Tightening

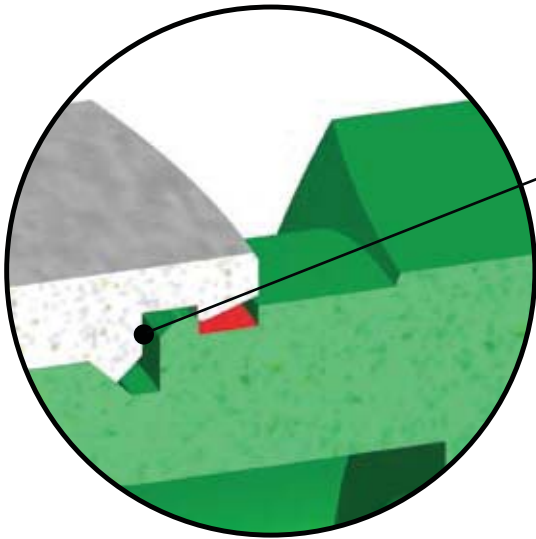

### Body / Nut Mechanical Stop

DK-LOK VR Series Tube Fitting provides LIFETIME leak-tight service.  
One more thread on body

The patented GROOVE constructed both on Nut and Body allows no over-tightening beyond 1 1/4 turns in the initial & re-tightening installation.

Over-tightening is not feasible in the DK-LOK VR Series Tube Fitting mechanically that is designed to provide precise 1 1/4 make-up turns keeping the four components of front, back ferrule, nut and body fatigue-free for extended lifetime service.

## Product Identification / Visual Inspection



1-1/4" Turn  
→



The red color on body identifies DK-LOK VR Series Tube Fittings. It is disappeared by the nut when the fitting's make-up is completed with 1 1/4 turns beyond finger tight position.

The identification helps fitters eliminate the make-up inspection with a gap gauge; it further facilitates operator's visual inspection on the running system.

## Pressure- Temperature Ratings

illustration

As shown on above illustration, nothing is different from the design of Standard DK-LOK Tube Fittings except the construction area of groove on body. The gap between body and tube thread is enhanced where the groove is on.

DK-LOK VR Series Tube Fitting is identical to the standard DK-LOK Twin Ferrule Tube Fitting in pressure - temperature rating, installation and re-installation.

## Applications



The outstanding feature of HOOK design never allows DK-LOK VR Series Tube Fitting in service to loose the nut resulting in system failure & leakage. the application includes where extreme vibration is going on such as turbine, compressor, machine, automotive, CNG and NGV industries, where thermal shock, extreme impulse such as power generation, equipment, where leak-tight service must be in place such as hazardous gas and offshore industries.

## Materials of Construction

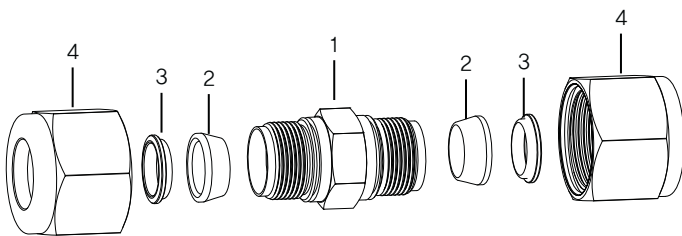

Components	Materials
1. BODY	ASTM A276/473 TYPE316
2. FRONT FERRULE	ASTM A276/473 TYPE316
3. BACK FERRULE	ASTM A276/473 TYPE316
4. NUT	ASTM A276/473 TYPE316

## Ordering Information

To order VR Series Tube Fitting, select an applicable part number in the DK-LOK Tube Fitting Catalog, and insert **VR** in the part number.

Example: DMC 8-8N-**VR**-SA

1/4", 3/8", 1/2", 3/4", and 1" OD are available for supply.

## Features of VR Series With Bushing Tube Fitting



- Outstanding Vibration Resistant Design
- Stainless Steel Construction
- Improve on production efficiency by preventing of tube pull-out After tube insert
- Prevent Secondary leakage by O-Ring.
- Integration tube fitting with check marking.

## Materials of Construction

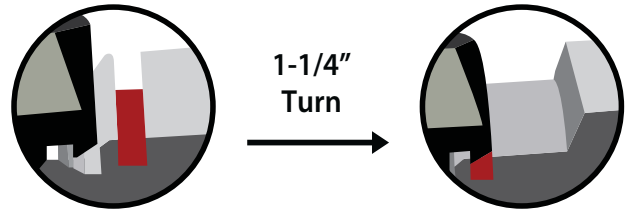

Embossment  
(4개소)

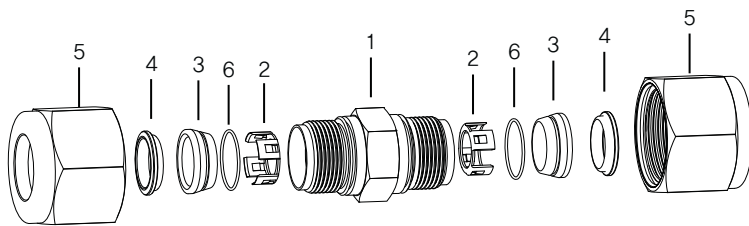

Components	Materials
1. BODY	ASTM A276/473 TYPE316
2. BUSHING	ASTM A276/473 TYPE316
3. FRONT FERRULE	ASTM A276/473 TYPE316
4. BACK FERRULE	ASTM A276/473 TYPE316
5. NUT	ASTM A276/473 TYPE316
6. O-RING	NBR

## Product Identification

DK-LOK VRB Series Tube Fittings is identified with "VR" marking on NUT and "VRB" marking on Body.

## Ordering Information

Due to its identity with standard DK-LOK Tube Fitting, to order VRB Series, select an applicable part number in the DK-LOK Tube Fitting Catalog, and insert VRB in the part number.

Example: DMC 8-8N-VRB-SA

The following sizes of DK-LOK VRB Series fittings are available for supply.

1/4", 3/8", 1/2", " OD

**DK-LOK**<sup>®</sup>  
Fittings & Valves  
www.dklok.com

**DK Tech Corporation**  
Mailing Address  
1465, Seobu-ro, Juchon-Myeon, Gimhae-si,  
South Korea 621-841

DK TECH contact information  
Tel. (82) 55-338-0114  
Fax (82) 55-338-6745  
E-mail: sales@dklok.com

For International customers  
Tel. (82) 55-338-0031/2  
Fax (82) 55-338-6746  
E-mail: dklok@dklok.com